

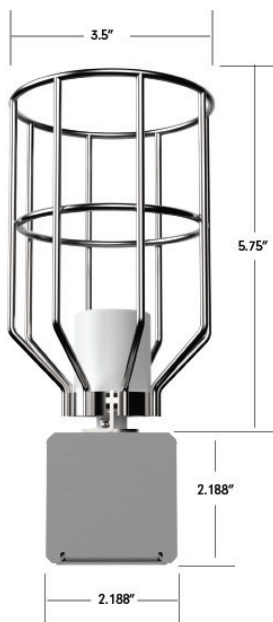

Project: _____ TYPE: _____

- Riveted Wire Guard meets NEC #520.72 standard
- Heavy-gauge extruded aluminum
- Available in 6", 9", 12" and 18" OC standard spacing
- Wiring and components are concealed
- Anti-corrosion coated (Custom Finished on Request)
- Custom radial bends
- 2.188" x 2.188" Standard Profile extrusion available
- Optional 4 Channel chase wiring is available
- Configurable for freight optimization
- Pre-wired for quick and easy installation
- Knock-out holes for screws are provided every 24"
- 7/8" diameter knockouts on mounting side (custom optional end cap knockouts)

Dimensions



Order Guide

AC Standard Architectural Channel maximum length 12'

| PRODUCT CODE | SOCKET TYPE | LAMP SPACING | FINISH |
|----------------------|-----------------------------|--|--|
| AC | WB | | |
| AC = Standard | WB = Wire Guard Base | 06 = 6" OC 09 = 9" OC 12 = 12" OC 18 = 18" OC 24 = 24" OC | SA = Satin Aluminum BK = Black Powder Coat WH = White Powder Coat |

Specification

| Electrical | |
|---------------------------|--|
| Operating Voltage | 120V AC/ 240V AC |
| Physical | |
| Dimensions | AC Standard 2.188" W x 2.188" H (without bulb) |
| Socket Spacing* | 6", 9", 12", 18" and 24" OC |
| Order increments | 1' (12' max) |
| Housing | Aluminum |
| American Wire Gauge | 20 AWG |
| Mounting | Surface Mount, Suspended |
| Knock-out Holes | Every 24" along mounting face of channel |
| Sockets | Medium Base, E26/E27 |
| Lamps (By others) | 60W max |
| Certification and Testing | |
| Certification | cULus |
| Environment | Dry Location |
| IP Rating | IP54 |
| Warranty | 5 Years |

*Custom lamp spacing available (consult factory)

**Custom paint or anodizing available (consult factory)

Accessories and Joiners

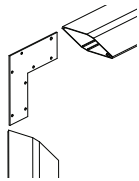

AC-90
Flat 90° (Standard)
Internal 90° Bracket

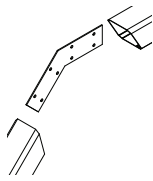

AC-45
45° Bracket (Standard)
Internal 45° Bracket

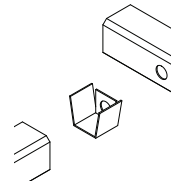

AC-T
T Bracket (Standard)
internal T-bracket

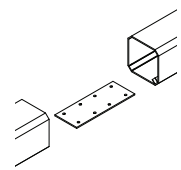

AC-180
Internal Connector (Standard)

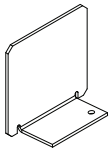

AC-EC-XX
XX = SA (Satin Aluminum),
PW (Powder Coated White),
PB (Powder Coated Black)
Standard Profile End Caps

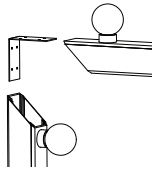

AC-90-OI
90° (Standard Outside/Inside)
Internal 90° Bracket

Channel Configurations

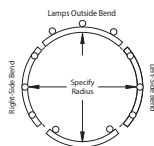

RADIUS
Radius bend set up charge
(Over 3' Radius)
Note: Indicate lamp position at
time of ordering

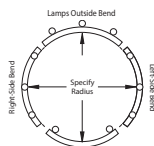

RADIUS-3
Radius bend set up charge
(Under 3' Radius)
Note: Indicate lamp position at
time of ordering

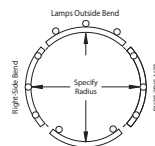

R-UNITS
Radius unit charge, Per 8' Max
length
Note: Indicate lamp position
at time of ordering

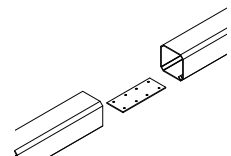

AC-RADIUS
Internal Bracket

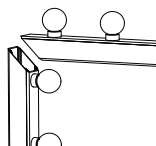

AC-MITER
Factory Miter Cut